



LAVORI DI RISTRUTTURAZIONE E
RIQUALIFICAZIONE DELL'AREA "CAMPO DEI
MONACI" IN SAN GIORGIO DEL SANNIO
ALLA VIA SANT'ANTONIO

PROGETTO ESECUTIVO

8.3

IMPIANTO ELETTRICO
SCHEMA ELETTRICO
UNIFILARE SPOGLIATOI

Visto: Il committente



Il Progettista: Ing. LOMBARDI RAFFAELE

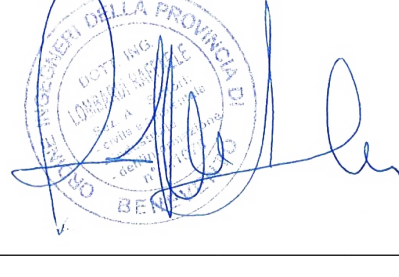

Rev.: 01





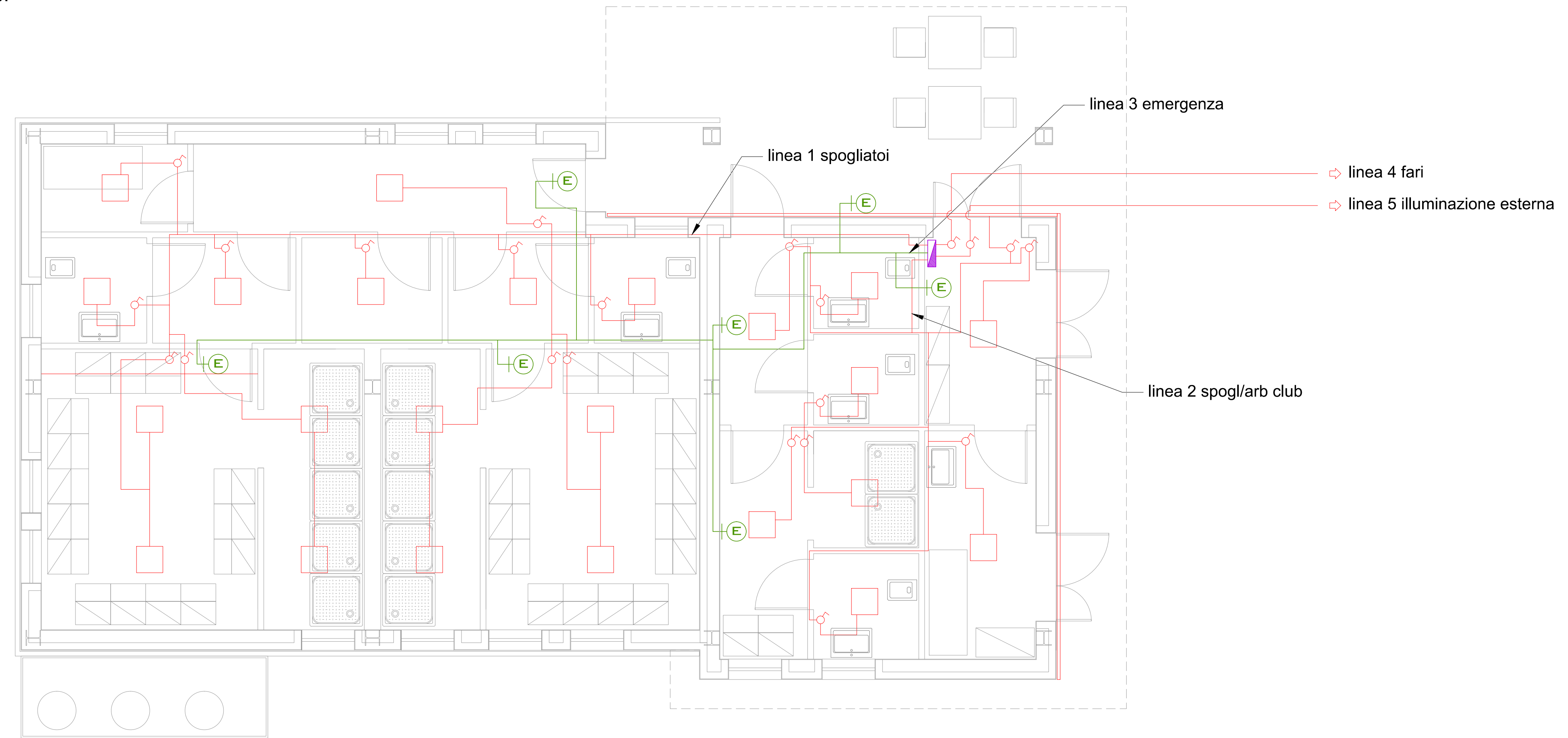

Data: Marzo 2023

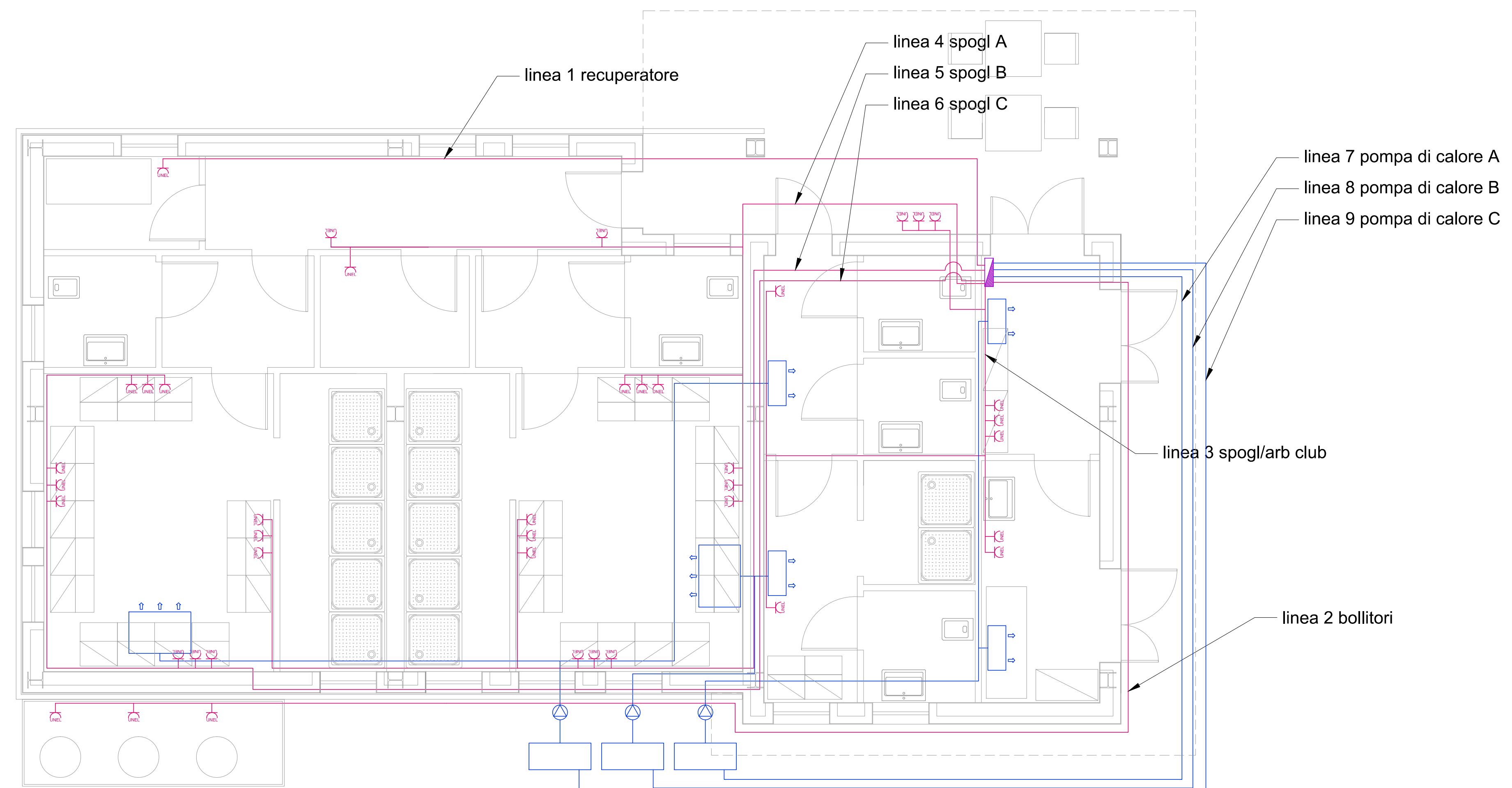
LINEA LUCI



LINEA FORZA MOTRICE



-  INTERRUTTORE UNIPOLARE
-  PRESA UNEL
-  PUNTO LUCE A SOFFITTO
-  STRIP LED
-  PUNTO LUCE EMERGENZA
-  QUADRO ELETTRICO